

Crawford county

S. 88 1/2° E. 331 perches.

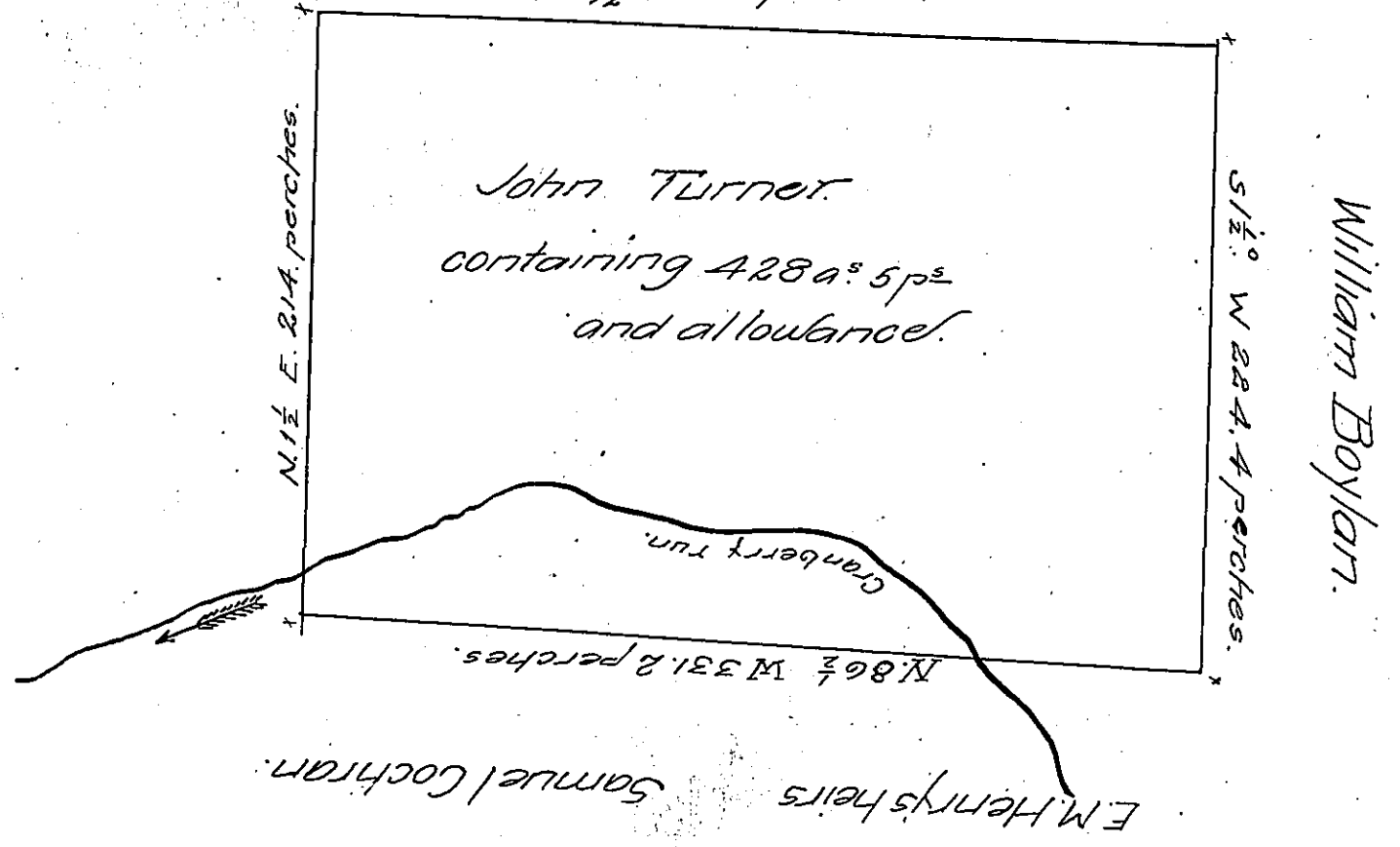

The above is a sketch of survey made for John Turner in Deer creek township, Mercer county on the waters of Sandy creek and containing four hundred and twenty eight acres five perches and allowance about 100 acres improved claimed in pursuance of an actual settlement made by him and I do hereby certify that from the survey books and official documents in my possession the above described and applied for tract of land has not been appropriated or surveyed to any other person than said applicant or any other person under whom he claims the same by warrant or otherwise. In witness whereof I have here to set my hand this 26th day of November A.D. 1857.

W^m W. Pearson.
County Surveyor.

To Surveyor General.

IN TESTIMONY that the above is a copy of the original remaining on file in the Department of Internal Affairs of Pennsylvania, made conformably to an Act of Assembly approved the 16th day of February 1833, I have hereunto set my hand and caused the Seal of said Department to be affixed at Harrisburg, this Sixth day of March 1907.

Joseph R. Brown
Secretary of Internal Affairs.